

ENGR26 – TEST NO. 4

NAME: _____

This is just a

Sample Test

Make sure you understand the problems discussed in class as well as the homework.

GENERAL INFORMATION

- ❑ This sheet must be stapled together with your printout.
- ❑ Title block information:
 - The title block will need to be exploded when inserted.
 - Complete as required (Name, Date, etc.).
 - SECTION ?? 8:30 AM etc. (ex. SECTION: 8:30 AM)
 - Block Insertion point is 0,0
 - Block Scale should be 1.00
- ❑ Center lines should extend about 0.25" (6 mm) past the object when printed.
- ❑ Don't print the View port box.
- ❑ You may need to draw temporary lines from one view to the other to find points, then trim the objects. If you are unsure of which points line up then please ask.
- ❑ Printout your solutions using the monochrome setting.
- ❑ Objects should be placed on the appropriate layer.
- ❑ Labels such as FRONT, TOP, RIGHT SIDE and SECTION should be placed in paper space on the Border layer.
- ❑ The text size should be 0.125" (3.2 mm) when printed (except for the title block).
- ❑ **Save often.** I recommend every 5 minutes. I am not very understanding should you lose your file.
- ❑ If you have any questions please ask (I make mistakes too!).

PROBLEM 1 DRAWING SPECIFIC INFORMATION

- **TEMPLATE:** None
- **SAVEAS:** Z:\TEST4-1.dwg
- **BORDER:** Q:\ENGR26\CUESTA TITLE BLOCK.dwg (or-metric)
- **VIEWPORT SCALE:** 1:1 or 1:2 or 1:3 or 1:4 (The scale on the Plot menu is always 1:1 because that refers to paper space, not the *viewport*).
- Given the views below, construct the FRONT, R. SIDE, and true shape of the inclined surface. Label each point in the auxiliary view and the other views.
- Find the area of the inclined surface and type it on your exam.
- Do not dimension.

Answer: Area ≈ 2.6 to 2.7

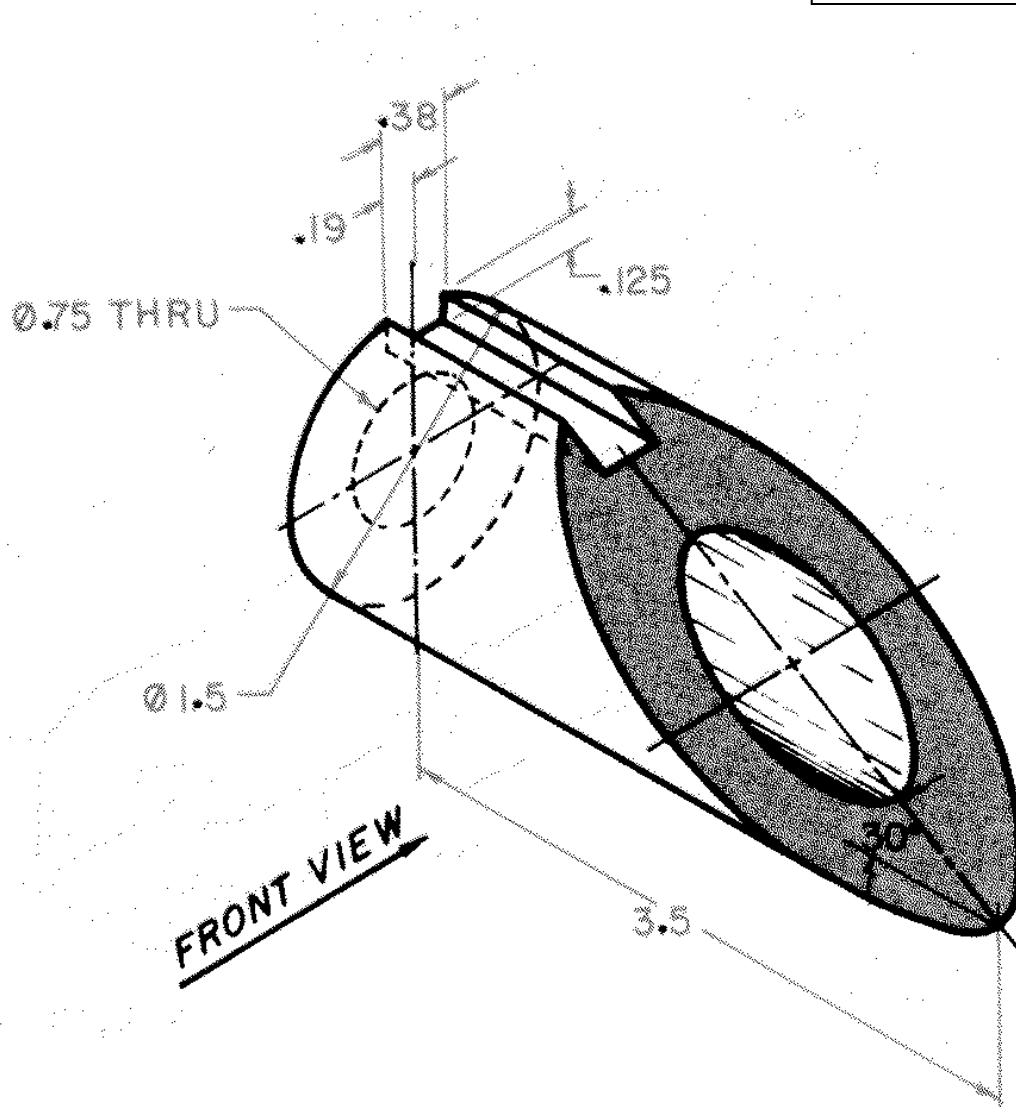

PROBLEM 2 DRAWING SPECIFIC INFORMATION

- ❑ **TEMPLATE:** Q:\ENGR26\Test4-2.dwt
- ❑ **SAVEAS:** Z:\TEST4-2.dwg
- ❑ **BORDER:** Q:\ENGR26\CUESTA TITLE BLOCK.dwg (or-metric)
- ❑ **VIEWPORT SCALE:** 1:1 or 1:2 or 1:3 or 1:4 (The scale on the Plot menu is always 1:1 because that refers to paper space, not the *viewport*).
- ❑ Given the views below, construct the FRONT, TOP, RIGHT SIDE, and true shape of the inclined surface. Label each point in the auxiliary views and the other views.
- ❑ Find the area of the inclined surface and type it on your exam.
- ❑ Don't print any construction or help lines.
- ❑ Do not dimension.

Answer: Area ≈ 2491

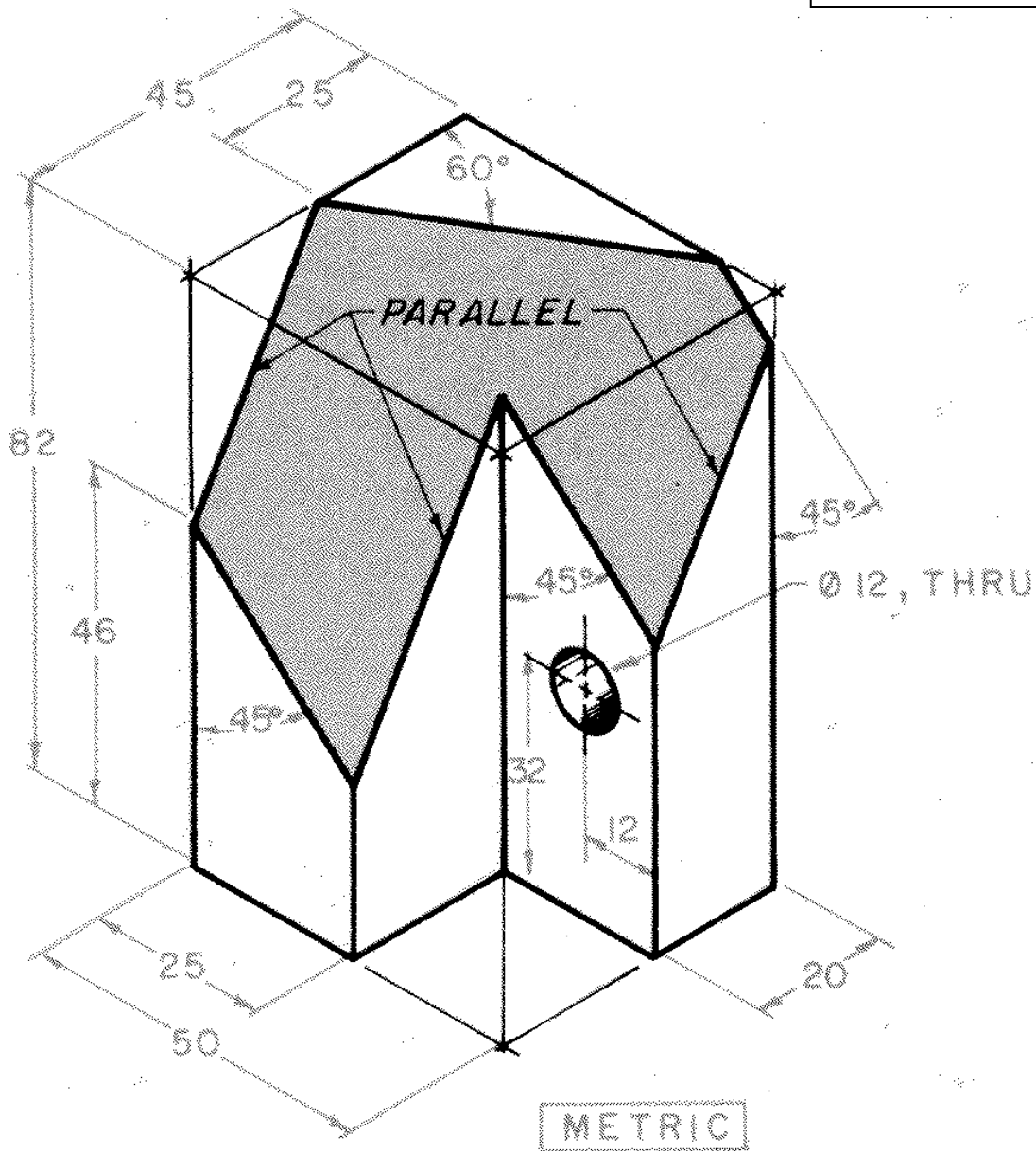

PROBLEM 3 DRAWING SPECIFIC INFORMATION

- ❑ **TEMPLATE:** None
- ❑ **SAVEAS:** Z:\TEST4-3.dwg
- ❑ **BORDER:** Q:\ENGR26\CUESTA TITLE BLOCK.dwt (or -metric)
- ❑ **VIEWPORT SCALE:** 1:1 or 1:2 or 1:3 or 1:4 (The scale on the Plot menu is always 1:1 because that refers to paper space, not the *viewport*).
- ❑ Given the views on the back, construct a working drawing.
- ❑ Dimension values to the nearest 1/4 inch (example 10.75)
- ❑ Finish should be 100 microns, material is Cast Iron, Tolerances are +/- 0.01 in. and 0.1°

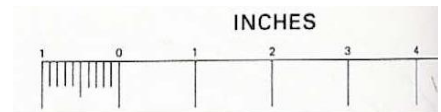

Use the ruler above to determine the dimensions of the objects. Don't worry about being too precise as I am primarily concerned with what and where you chose to dimension. You may want to cut the ruler out.

